

- █ AREA = 0.17 Ha (LEITRIM COUNTY COUNCIL LAND OWNERSHIP)
- █ AREA = 0.087 Ha (PROPOSED SITE BOUNDARY FOR PART 8 PLANNING PERMISSION APPLICATION)

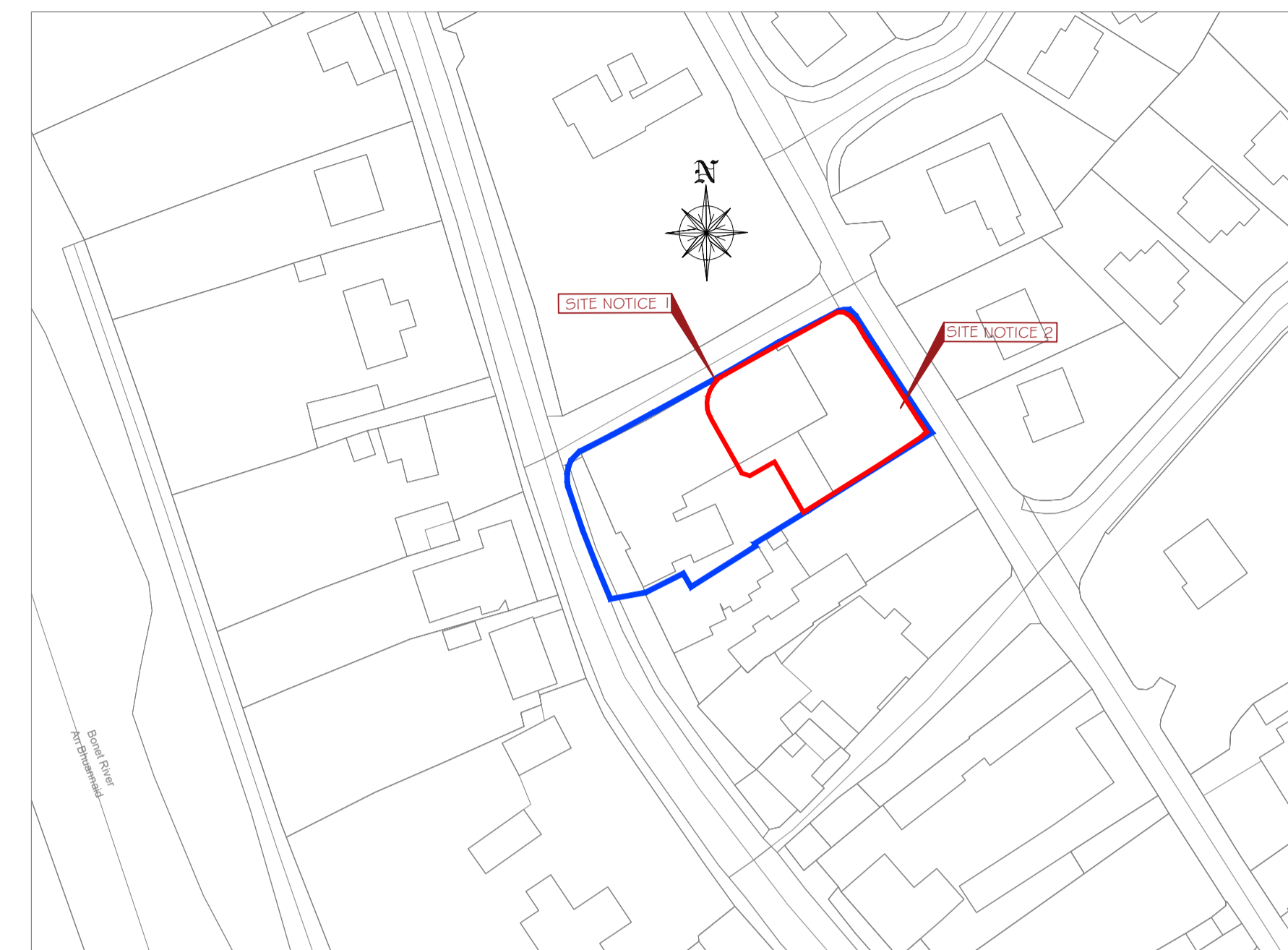
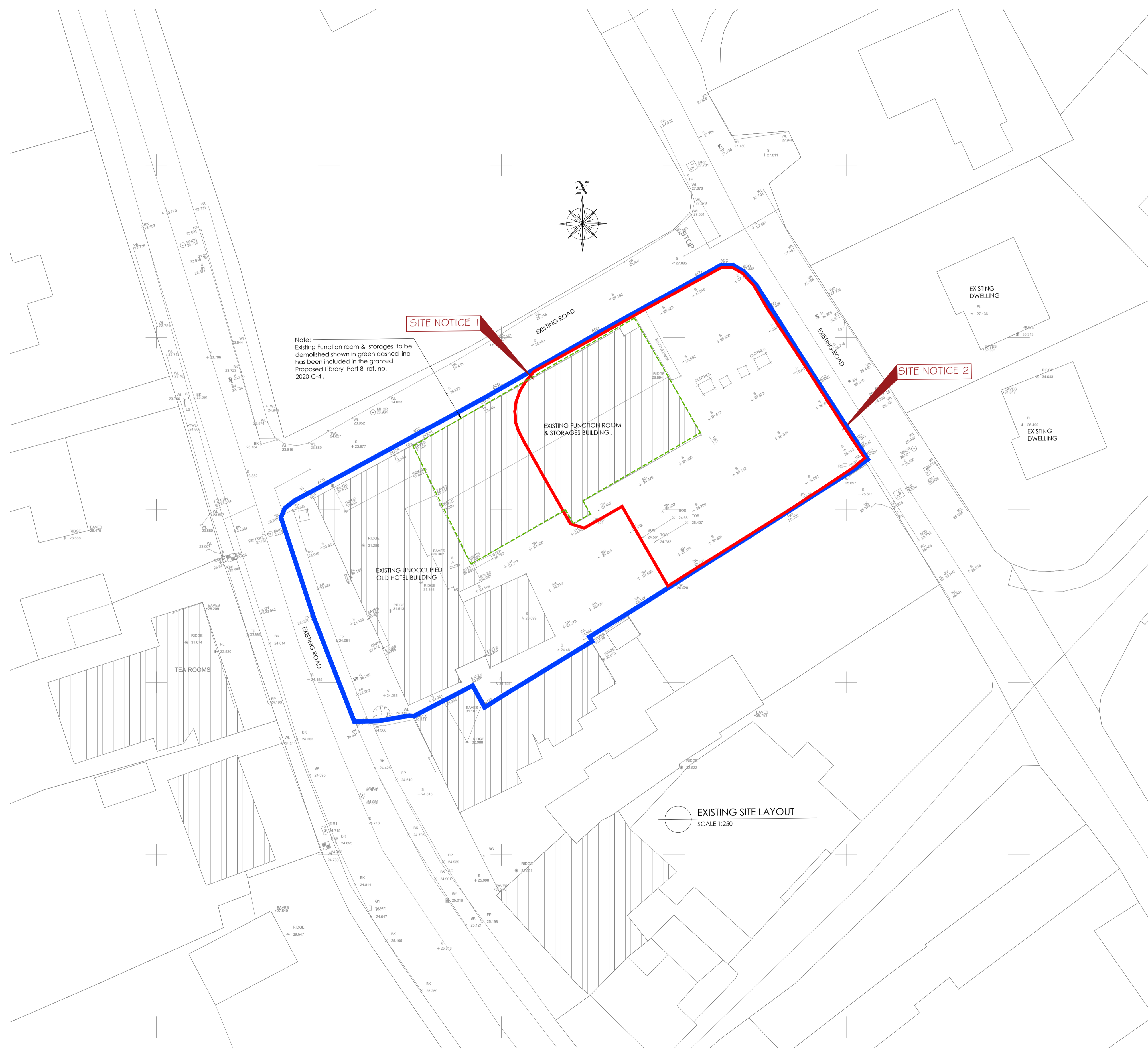

○ SITE LOCATION MAP
SCALE 1:1000

Description:
Digital Cartographic Model (DCM)

Publisher / Source:
Ordnance Survey Ireland (OSi)

Data Source / Reference:
PRIME2

File Format:
Autodesk AutoCAD (DWG_R2013)

File Name:
v_50135553_1.dwg

Clip Extent / Area of Interest (AOI):
LLX,LLY= 580197.5384,831190.4298
URX,URY= 580430.5384,831190.4298
ULX,ULY= 580197.5384,831362.4298
URX,URY= 580430.5384,831362.4298

Projection / Spatial Reference:
Projection= IRENET95_Irish_Transverse_Mercator

Centre Point Coordinates:
X,Y= 580314.0384,831276.4298

Reference Index:
Map Series | Map Sheets
1:2,500 | 1074-C

NOTES :
This drawing is copyright and may not be copied or altered without permission.
Use only figured dimensions. Do not scale this drawing.
The contractor is responsible for checking all dimensions on site prior to construction.
The Architects are to be notified of any discrepancies prior to work commencing.
Levels and contours, shown on drawings, are relative to local datum unless specified

REVISION	DATE	DESCRIPTION	INITIAL	REVISION	DATE	DESCRIPTION	INITIAL

LEITRIM COUNTY COUNCIL	
Proposed Residential Development	
Drumahaire, Dromahair, Co. Leitrim	
EXISTING SITE LAYOUT & SITE LOCATION MAP	
DRAWN BY: 20455	CHECKED BY: VARIES
DATE: 30-Jun-21	PROJECT NO: 20455-SRV -000

SWEENEY architects

PH: 043 334 5400
EM: info@sweeneyarchitects.ie
www.sweeneyarchitects.ie

SWEENEY architects
Studio 4, Green Park
Athlone Rd
Castlerea

RIA1
2021
G3